

Plastic Formed Pedestal Installations (PCOD)



FlashRight Displays
6210 Browns Bridge Rd.
Cumming, GA 30041
Tel. 678-455-9121
www.FlashRightDisplays.com

- **PLEASE READ WARNING STATEMENTS ON THE NEXT PAGE**
- **PLEASE REVIEW ADDENDUM PAGES A - C BEFORE INSTALLATION**

Warning Statements

- A qualified person should perform the installation procedure. Injury and/or damage can result from dropping or mishandling the display.
- Standard safety measures must be practiced at all times during the installation of this product. Use proper safety gear and tools for the installation procedure to prevent personal injury.
- Prior to installation of this product, the installation instructions should be read and completely understood. The installation instructions must be read to prevent personal injury and property damage. Keep these installation instructions in an easily accessible location for future reference.
- When working around an electrical source **make sure the electrical source has been shut off** and confirm with the appropriate testing device.
- **The FlashRight Display is a 12 Volt DC system** and must be used with the **plug-in 120 VAC to 12 VDC** power transformer supplied.
(Do not connect the 2 conductor Display wiring directly to 120 VAC)
- All wiring should meet or exceed **National Electric Codes (NEC)**
- **1 Year Warranty** on all FlashRight Display Components

For Technical Assistance call 678-455-9121

Mon-Fri 9 am - 5 pm

(Eastern Standard Time)

PLEASE READ Addendum Pages "A" thru "C" ON THE FOLLOWING PAGES BEFORE INSTALLATION

Display Connection to Power Supply

AC to DC
Power Transformer
12 VDC



Connect **BLACK** wire (-) to **BLACK** wire on
Display

Connect **RED** wire (+) to **RED** wire on
Display

AC to DC
Power Transformer
12 VDC

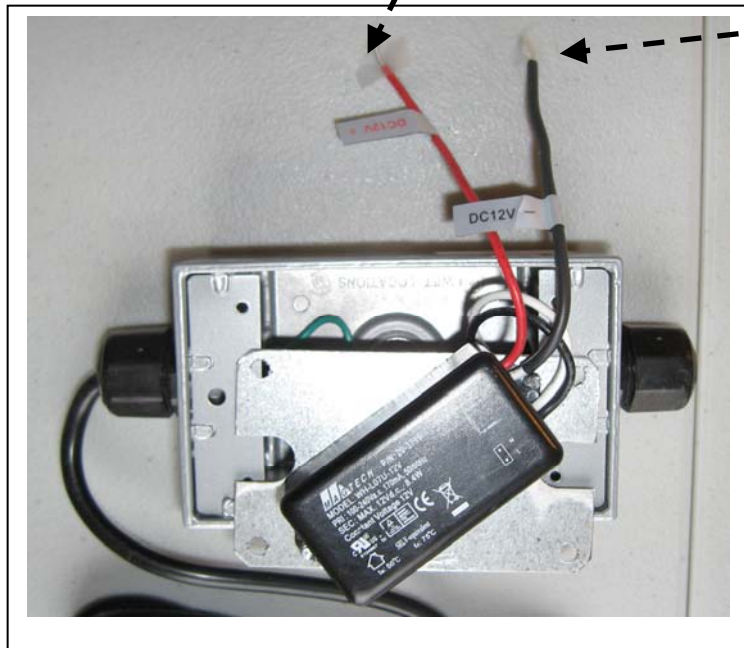

Connect **BLACK** wire
(-) to **BLACK**
wire on
Display

Note:

If you have to extend the wire run, make sure you use the same round type of 18 gauge wire with **RED** and **BLACK** conductors.

Make connections with the supplied Gel Filled wire connectors.

Addendum Page "A"

Brackets and Hardware Description

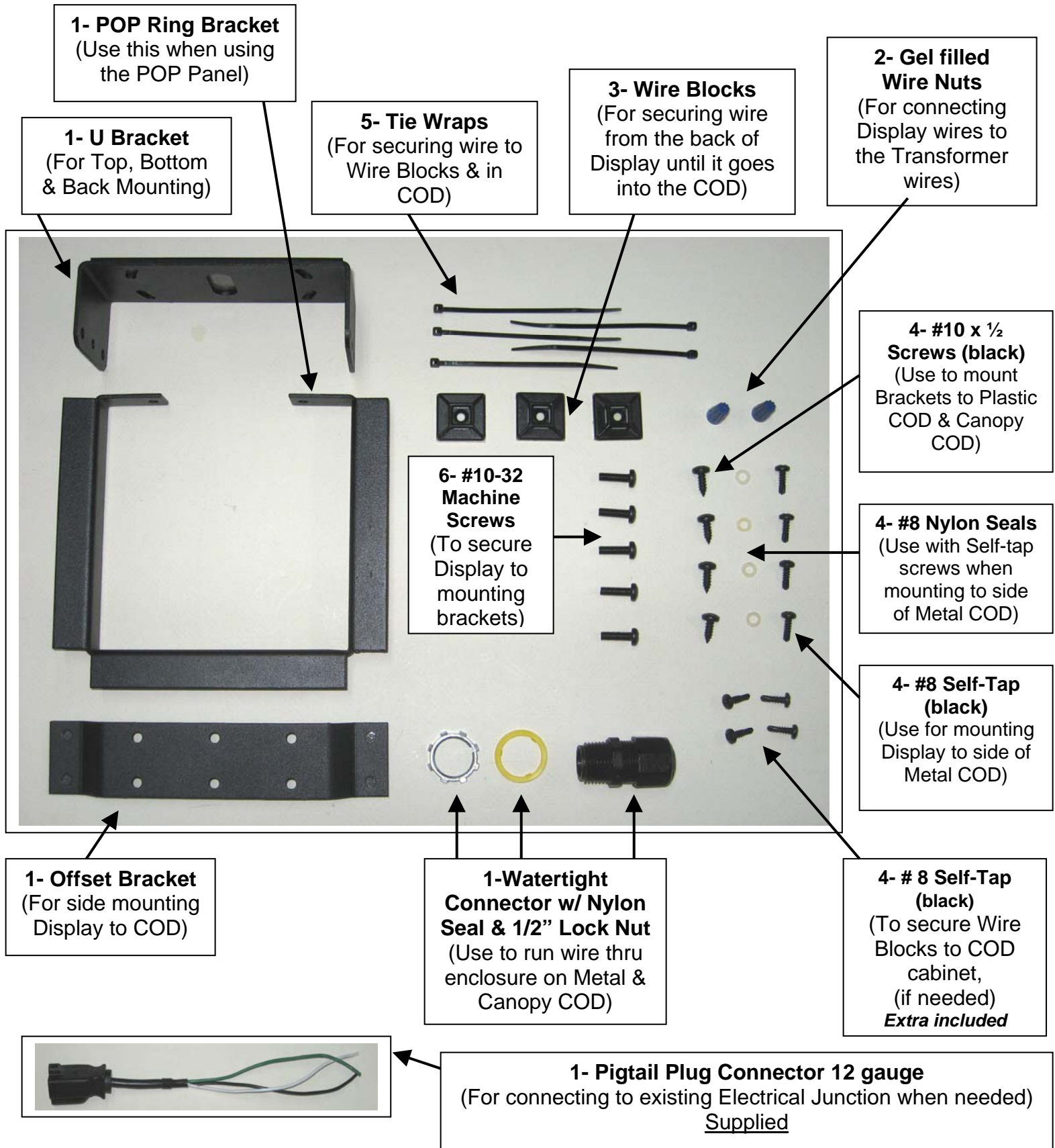

PLEASE REVIEW "MOUNTING BRACKET OPTIONS" ON NEXT PAGE BEFORE INSTALLATION

Addendum Pg. "B"

Mounting Bracket & Set-Up Guide

➤ Use this type of mounting if securing to the PCOD or where it is necessary to mount from the Top, Bottom or Back.

U Bracket Mounting (left side)



U Bracket Mounting (right side)

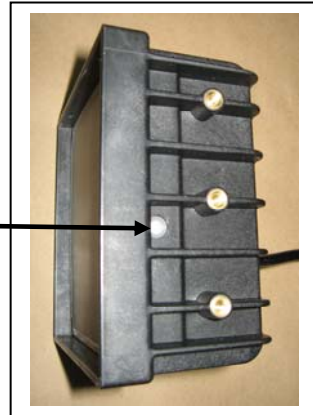

PCOD Mounting Method
Note Photo Cell location
Right Side

Model number is on Top of Display

Place the POP Trim Ring over the FRD and secure it using the bottom two holes and #10 machine screws



*** You will use the top 4 screw holes later to mount the FRD to the U Bracket on the PCOD***

Suggested Mounting Locations on CODs



Align the left side of bracket $\frac{3}{4}$ " to the right of the indent

Align the top side of bracket $\frac{3}{4}$ " lower than indent

Overview:

- There are 2 main types of Plastic CODs (PCOD). There may be some variations to each, however one type you will remove the front panel of the **PCOD** (10 screws). The other type you will remove a back metal access panel (6-8 screws).
- The following steps will give you a good idea on how to install the FlashRight Display (FRD) to the **PCOD**.

Suggested Tools & Materials Needed:

- >Cordless Drill with Phillips Head Tip >3/8" Drill Bit or Uni-bit >Flat Head & Phillips Head Screwdrivers
- > Wire Cutter/Strippers >Standard Pliers >Black Electrical Tape >RED Wire Nuts (rarely needed)
- > Other electrical parts may be needed depending on each individual installation

****Turn OFF power to the PCOD****

****Do not remove the front of PCOD until Step 4****

Steps:

- 1) Position the FlashRight Display (FRD) bracket approximately $\frac{3}{4}$ " to the Right of the left side indent and $\frac{3}{4}$ " below the top side indent (See addendum "C" pg. 5). Use the supplied 4- #10 x $\frac{1}{2}$ " screws and secure U Bracket to the front of the **PCOD**. (See addendum "C" pg. 5)

Note: Do not use the #8 self-tap screws to mount this bracket.

- 2) Attach the **FRD** to the bracket by using the top 4 **FRD** holes, use 4 of the supplied #10-32 (black) machine screws. **(Picture 1)**
- 3) Drill a 3/8" hole in the under side notch area as shown below, run the wire through this hole after you remove the front of the **PCOD**. **(Picture 2)**

Note: If you have the **PCOD** with the removable back panel you will need to drill the hole under the **FRD** centered, and just in front of the ridge on the **PCOD** **(Picture 3)**. Drilling in this area allows you to run the wire toward the back of the **PCOD** where the access panel is.

- 4) Remove the 10 screws along the sides and remove the base cover screws. Slide off the front side of the **PCOD** and feed wire through the front as shown. Run the wire through the small square notch that is at the top left side of the metal base. This will keep the wire out of the way and help keep it in place when replacing the front of the **PCOD**. **(Rest the front cover on the side of PCOD & run wire. Leave wire slack)**

Note: If the **PCOD** is the type that has a removable panel on the back side, remove the panel and run the wire toward the back top access area. Place your hand in the top area of the back access and you will be able to get the wire at that point.

(1)



(2)



(3)



Run wire under front of display and inside.

^ (Removable Front PCOD) ^

^ (Back Access PCOD) ^

- Run the wire through square hole in top of the metal base.
(Removable Front PCOD)

- Run the wire out of the top back side.
(Back Access PCOD)

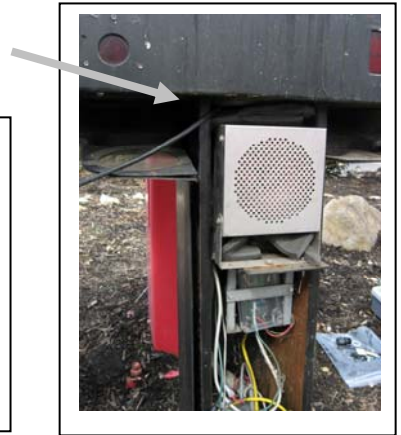

Now that the wire is run through the front part of the PCOD and the FRD is mounted to the front of the PCOD, you are ready to wire in the power supply.

- 5) Run the wire to the base area and leave enough wire to allow the front of the PCOD to be removed again. Cut off any excess wire you may not need. (make sure you do not cut too short)

Wiring in the Power Supply

- 6) Connect the RED wires from the FRD to the RED wire from the Power Supply. Do the same with the BLACK wires.
- 7) Plug in power supply to existing outlet inside in **COD** or wire in the pig tail connector to the 120 VAC power source.
- 8) Tape wiring connections if connecting directly to other open wiring.

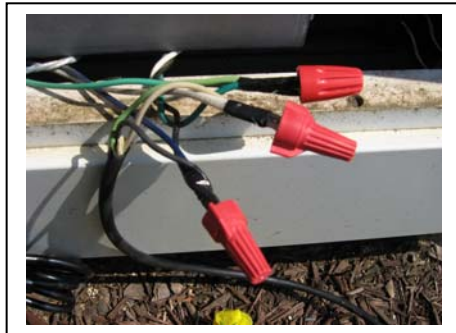

Note: Make sure you connect to the circuit that powers the COD and not to the circuit that powers the lighting in the Drive-thru area.

Note: All wiring should meet or exceed National Electric Codes (NEC)

- 19) ****Turn power breaker back ON****

- > Confirm unit is working. The **FRD** should be flashing at this time.
- > Place power supply out of the way and tie wrap excess wiring as needed.
- > Reassemble the **COD** and secure all screws or panels removed.

Attaching the POP Trim Panel

20) Separate the Velcro strips on the back of the POP Panel. Place the strips on the TOP, BOTTOM and RIGHT SIDE of the POP Ring Bracket. Slide the POP Trim Panel over the FRD and push against the areas where the Velcro strips are.

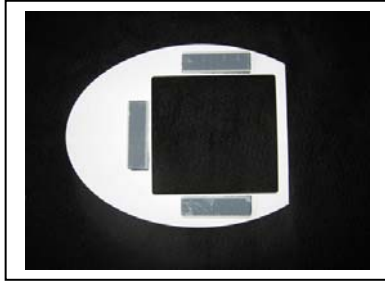

Photocell Test

- 1) Place a piece of black tape over the photocell on the Right Side of the **FRD**.
- 2) Wait approximately 45 seconds to 1 minute. The **FRD** will dim to about 50% brightness.
- 3) Remove tape and wait approximately 45 seconds and the **FRD** will come back to full brightness.

Note: If you are installing the **FRD** at dusk or during the night time the **FRD** may already be in the Dim Mode and it will NOT dim anymore.

To test during night time

Shine a flashlight over the photocell for approximately 45 seconds to 1 minute. The **FRD** will go to full brightness. Remove flashlight and wait, the **FRD** will go back to 50% brightness.

For Technical Assistance call 678-455-9121
Mon-Fri 9 am - 5 pm
(Eastern Standard Time)

FlashRight Displays – 6210 Browns Bridge Rd. - Ste. # 260 - Cumming, GA 30041
Tel. 678-455-9121 <<< >>> www.FlashRightDisplays.com

Flash Right Insert Panel Replacement

- 1) Place panel removal key (or any key) in one of the bottom slots and pry open.



Do the same on the other side.

Note: Use the same movement as if you would be opening a can of paint.



Panel will drop out and down.

- 2) Take the new panel and slide it up behind the dimples on the top and "snap" the bottom in place.

Make sure it is behind the 2 dimples on the top.



- 3) Make sure the top and bottom is "snapped" in place.



If you have the POP Trim Panel it will be easier to place the top in first and then "snap" in the bottom.

Note: It is recommended that you hold the back of the display when snapping the Insert Panel in place.

Installation Notes